

ALIGNMENT - ROAD 1 CL - LONGSECTION  
SCALE: H 1:500,V 1:500. DATUM: 10.000

NOTES - GENERAL

- All dimensions in metres unless stated otherwise.
- Refer to drawing SK201 for long section locations
- All works shall be in accordance with the Highway Authority's approved documents and satisfaction. Any reference to the specification shall mean the general specification for roadworks.

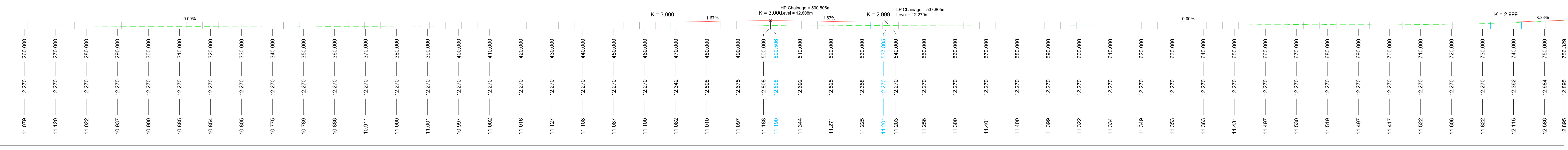
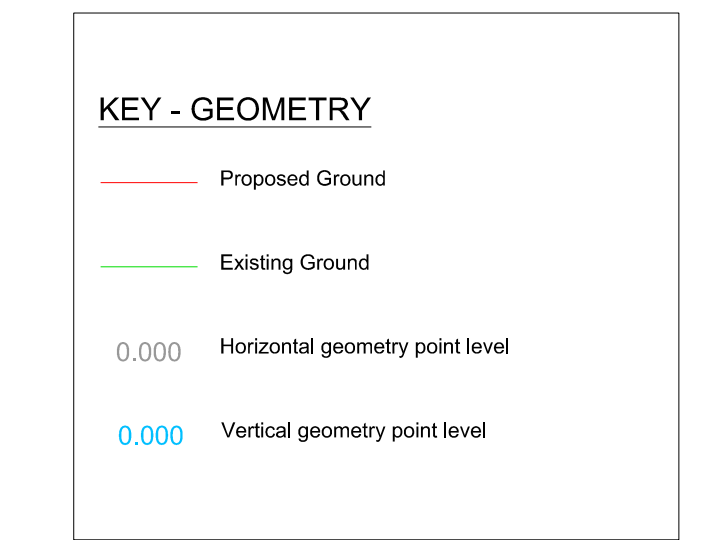

ALIGNMENT - ROAD 1 CL - LONGSECTION (Continued)  
SCALE: H 1:500,V 1:500. DATUM: 10.000

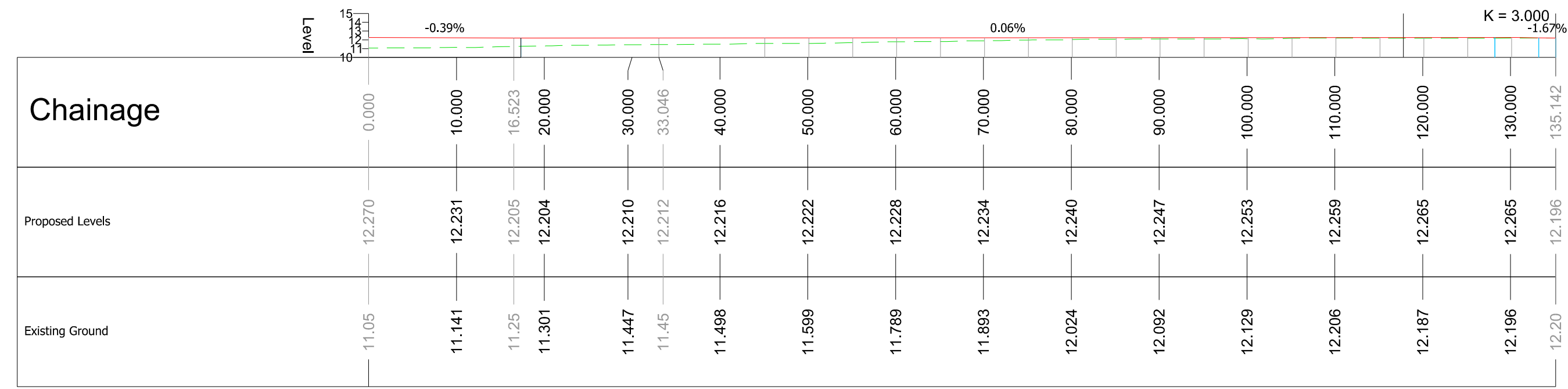

ALIGNMENT - ROAD 2 CL - LONGSECTION  
SCALE: H 1:500,V 1:500. DATUM: 10.000

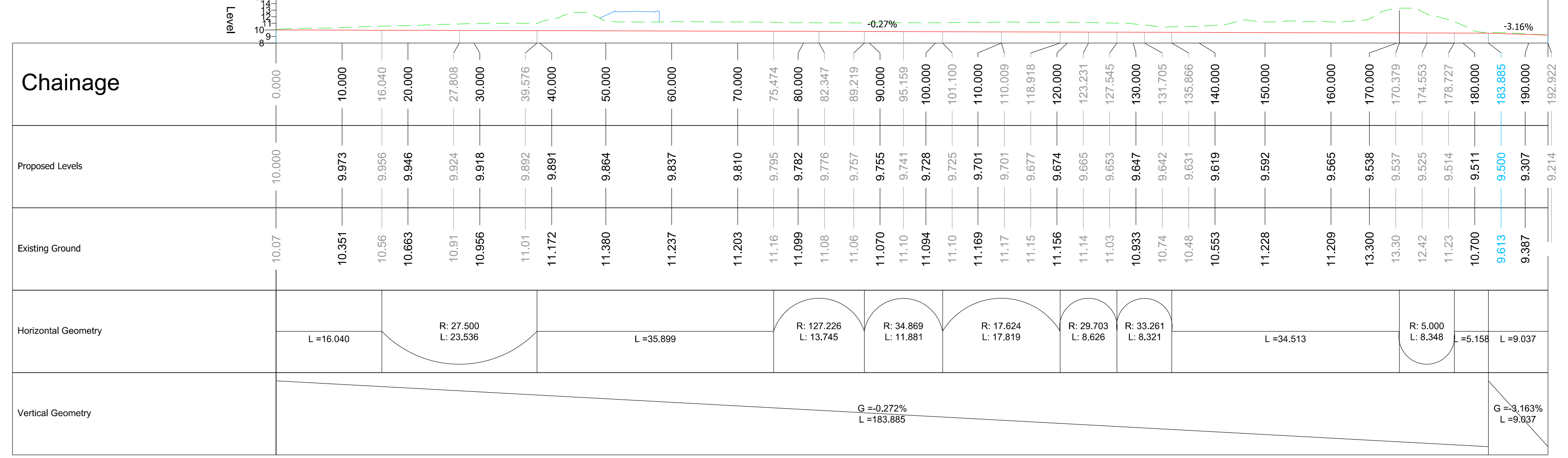

ALIGNMENT - FLOOD RELIEF CULVERT - LONGSECTION  
SCALE: H 1:500,V 1:500. DATUM: 8.000

PRELIMINARY ISSUE

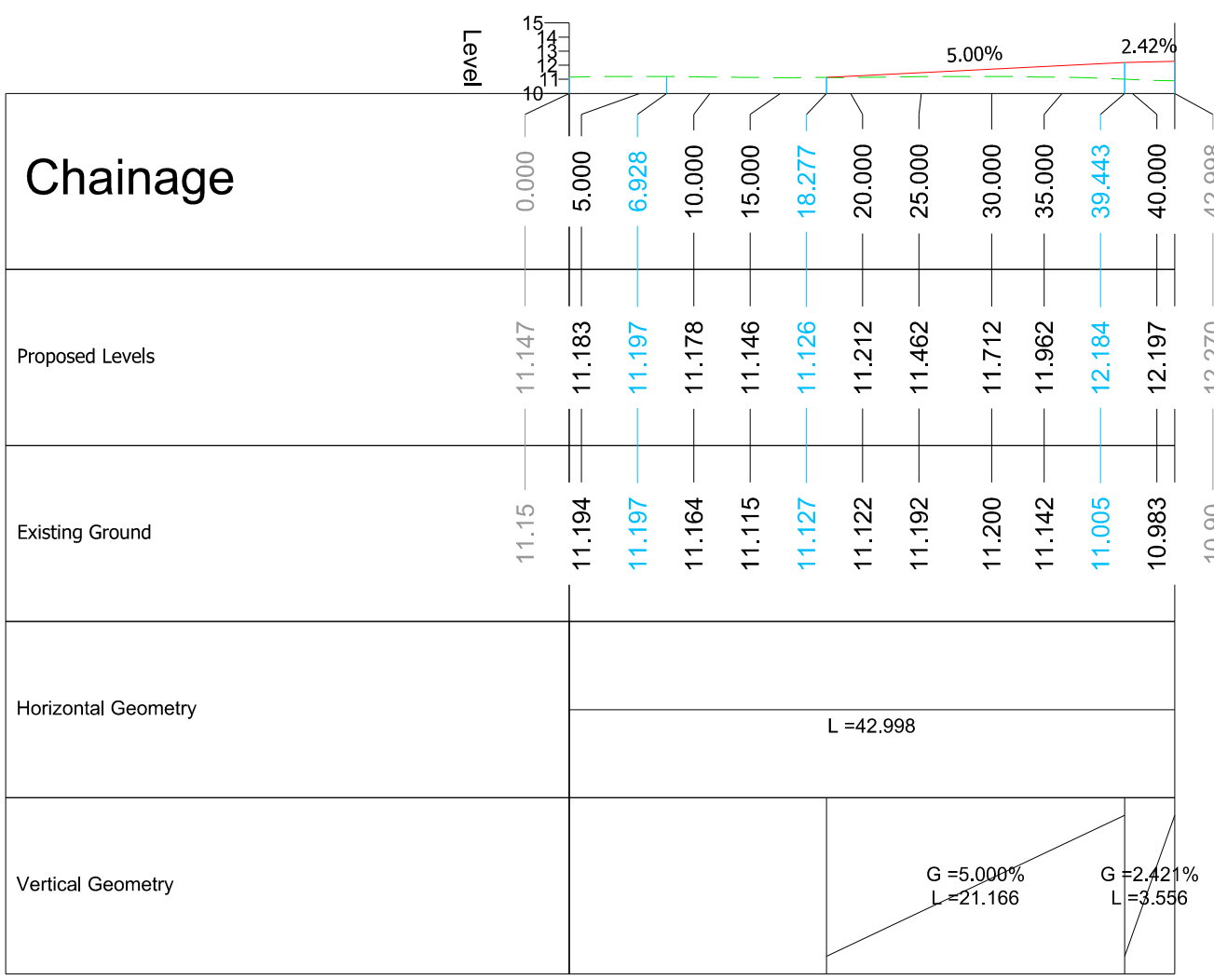

ALIGNMENT - TS1 CL - LONGSECTION  
SCALE: H 1:500,V 1:500. DATUM: 10.000

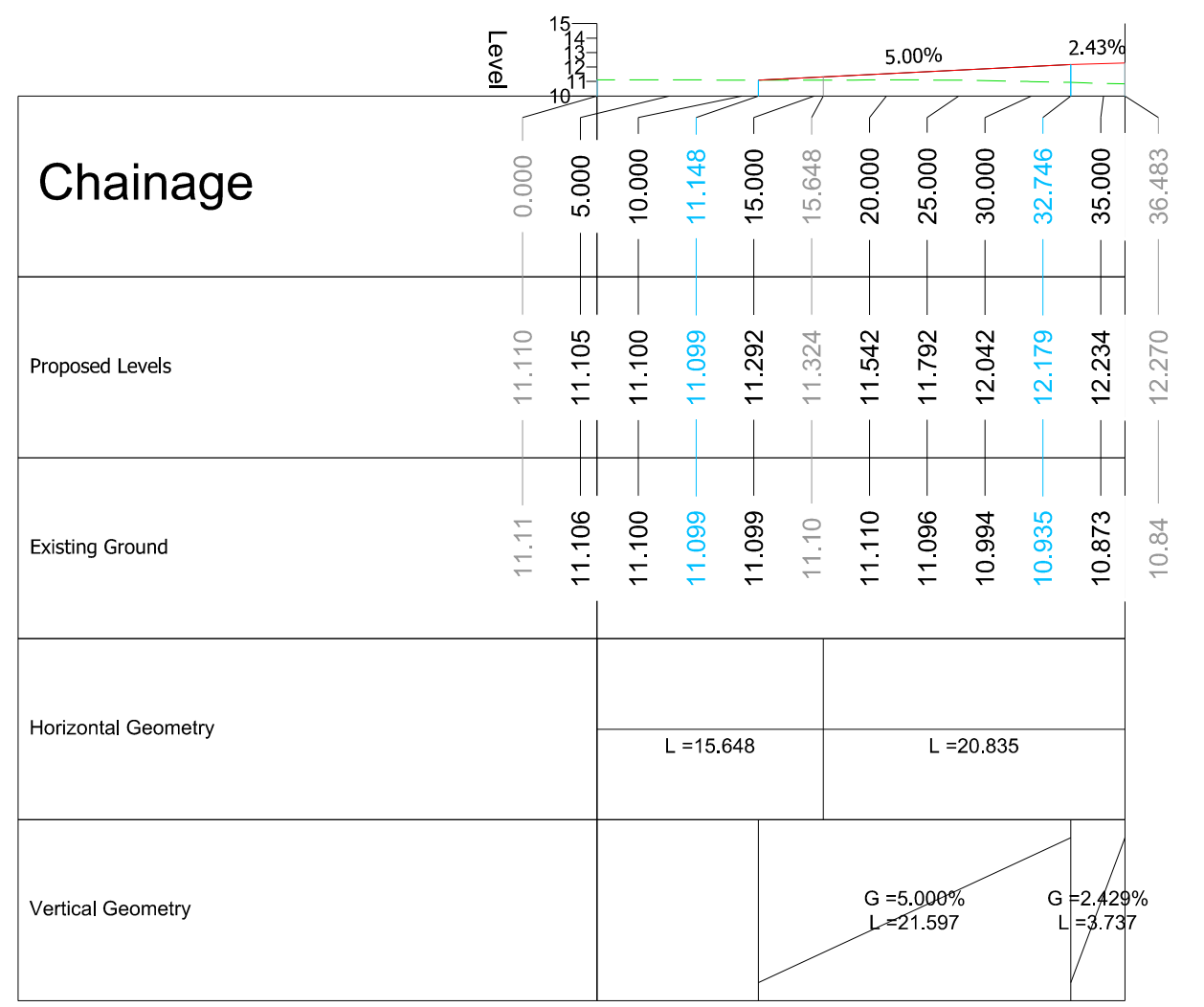

ALIGNMENT - TS2 - LONGSECTION  
SCALE: H 1:500,V 1:500. DATUM: 10.000

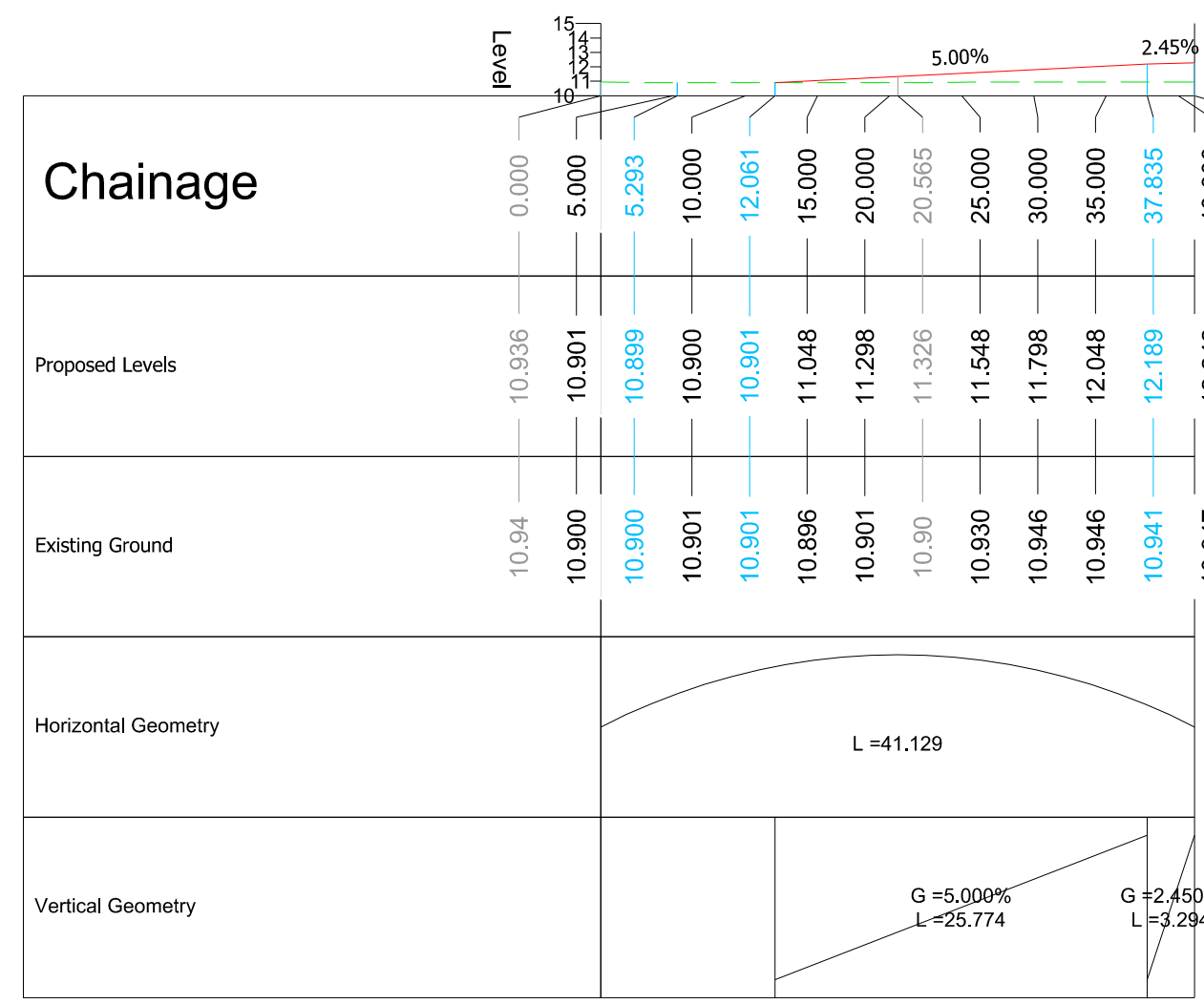

ALIGNMENT - TS3 CL - LONGSECTION  
SCALE: H 1:500,V 1:500. DATUM: 10.000

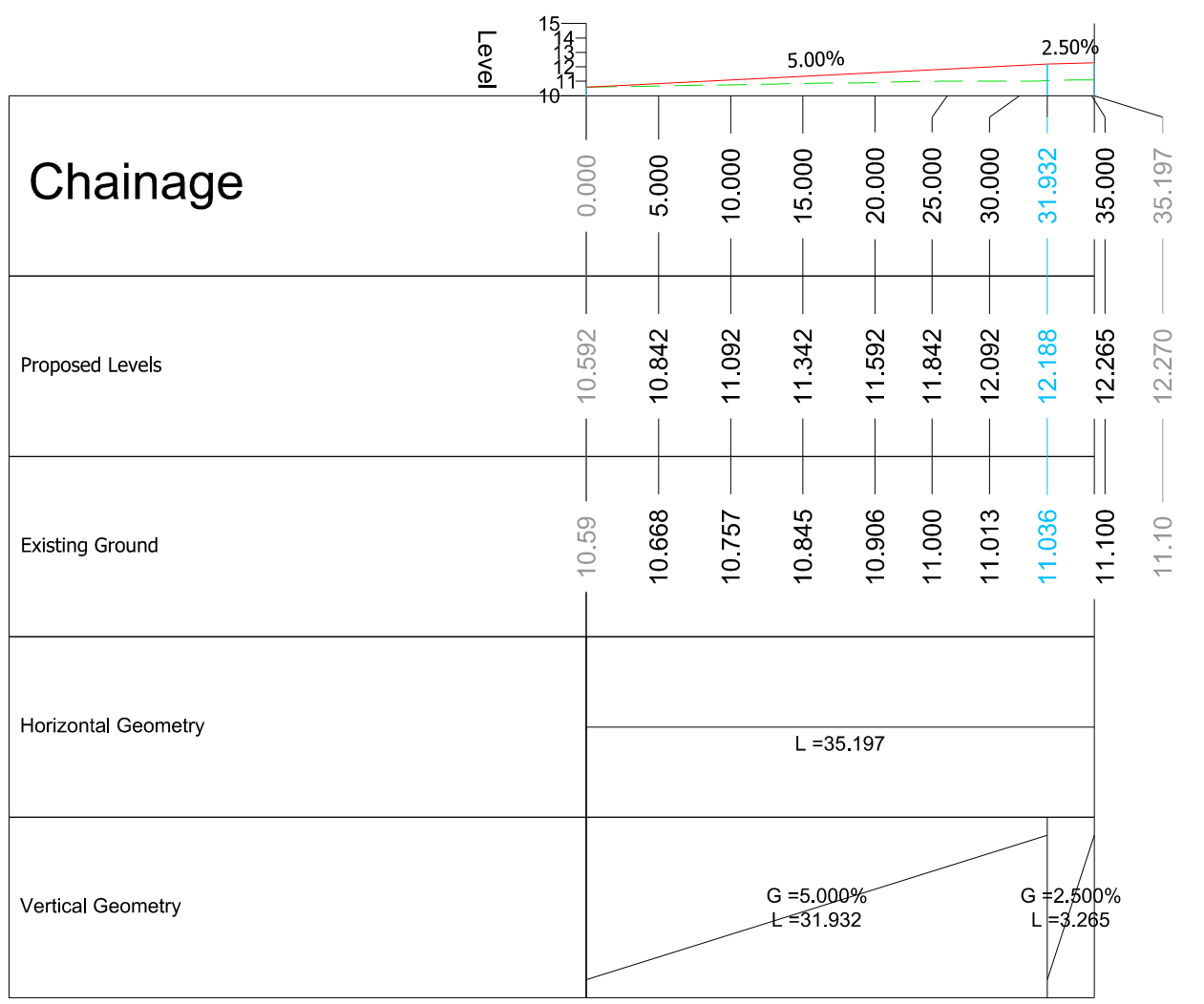

ALIGNMENT - TS4 CL - LONGSECTION  
SCALE: H 1:500,V 1:500. DATUM: 10.000

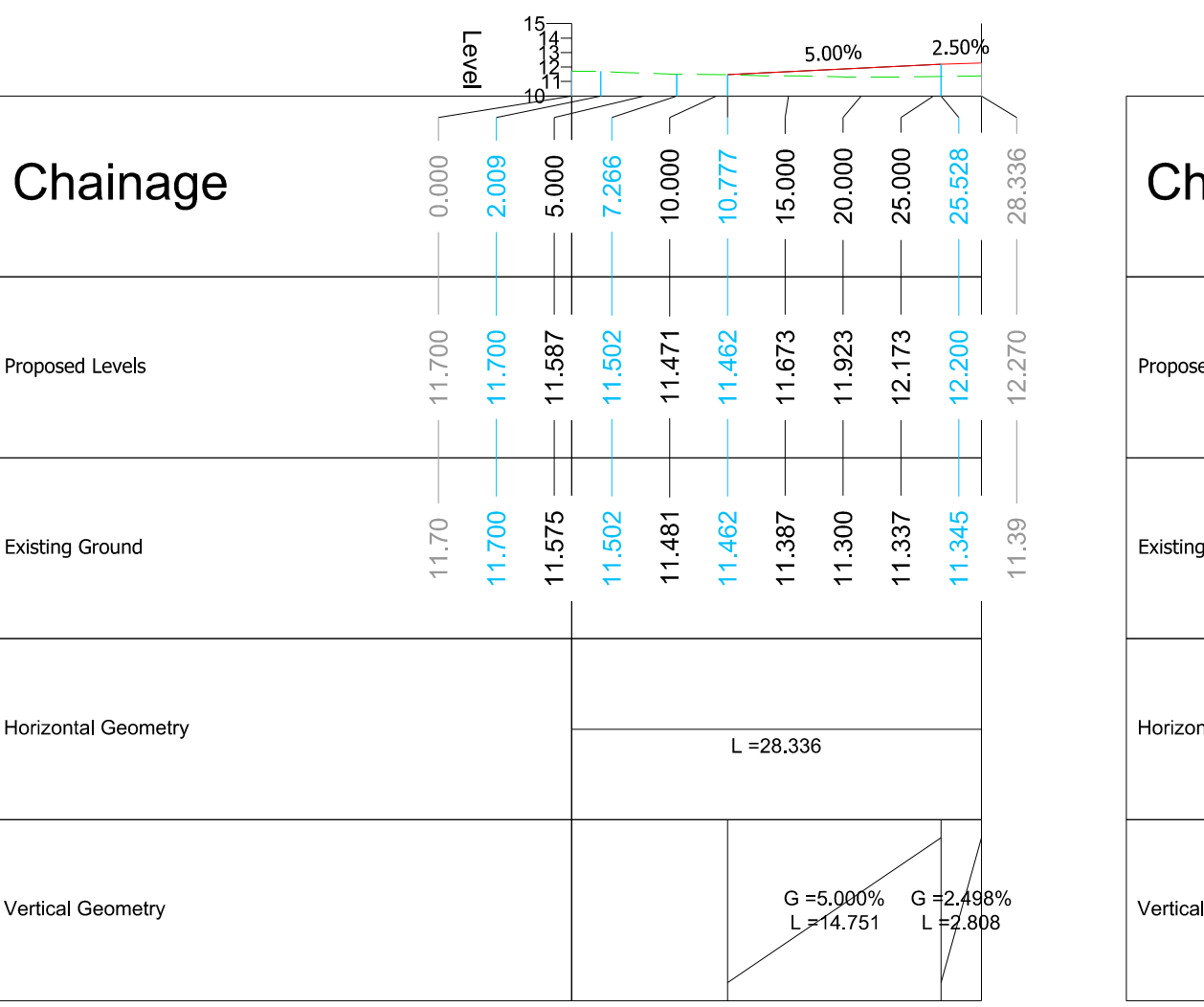

ALIGNMENT - RIVERSIDE CAR PARK CL - LONGSECTION  
SCALE: H 1:500,V 1:500. DATUM: 10.000

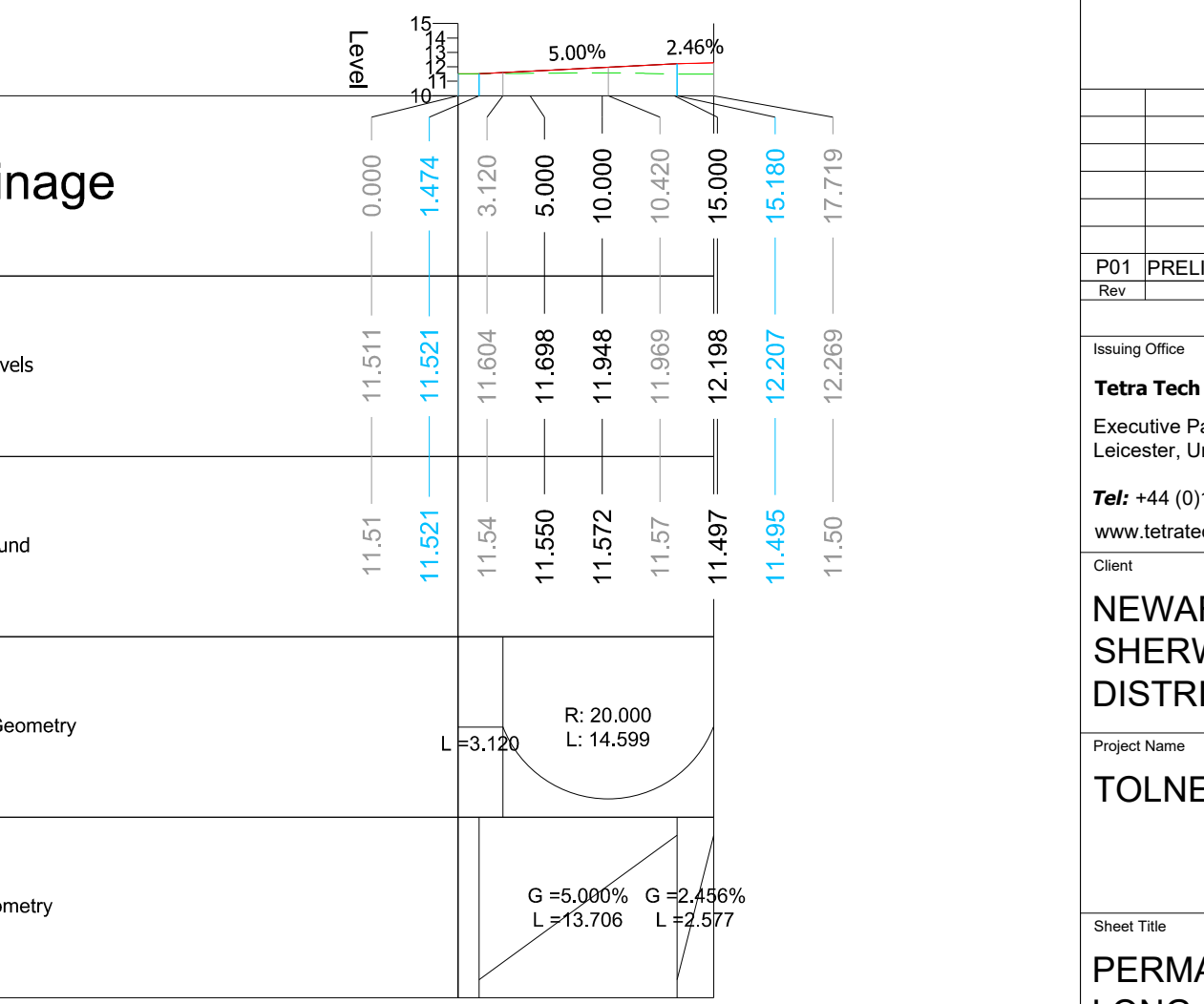

ALIGNMENT - RIVERSIDE PARK CL - LONGSECTION  
SCALE: H 1:500,V 1:500. DATUM: 10.000

Rev	Description	Date	By	Appr	PC
01	PRELIMINARY FIRST ISSUE	22.06.2022	MM	PC	

Issued For: Tetra Tech Leicester  
Executive Park, Aviation Way, Anstey, Leicester, United Kingdom, LE7 7GR  
Tel: +44 (0)115 234 8000  
www.tetra-tech.co.uk



Client: NEWARK AND SHERWOOD DISTRICT COUNCIL  
Project Name: TOLNEY LANE FAS



Sheet Title: PERMANENT HIGHWAY WORKS LONG SECTIONS

TTE Project Number	784-B039140	Drawn By	MM	Checked By	MM	Date	Jun 22	Scale	As Shown	Sheet No	50
Client Project Number	B039140	Contract	TTE - 00XX - ZZ	DR	CH	SK301	P01				